

START PROJECT  
COUNTY ROUTE 606  
(HAMILTON AVE.)  
STA. 103+36  
M.P. 1.96

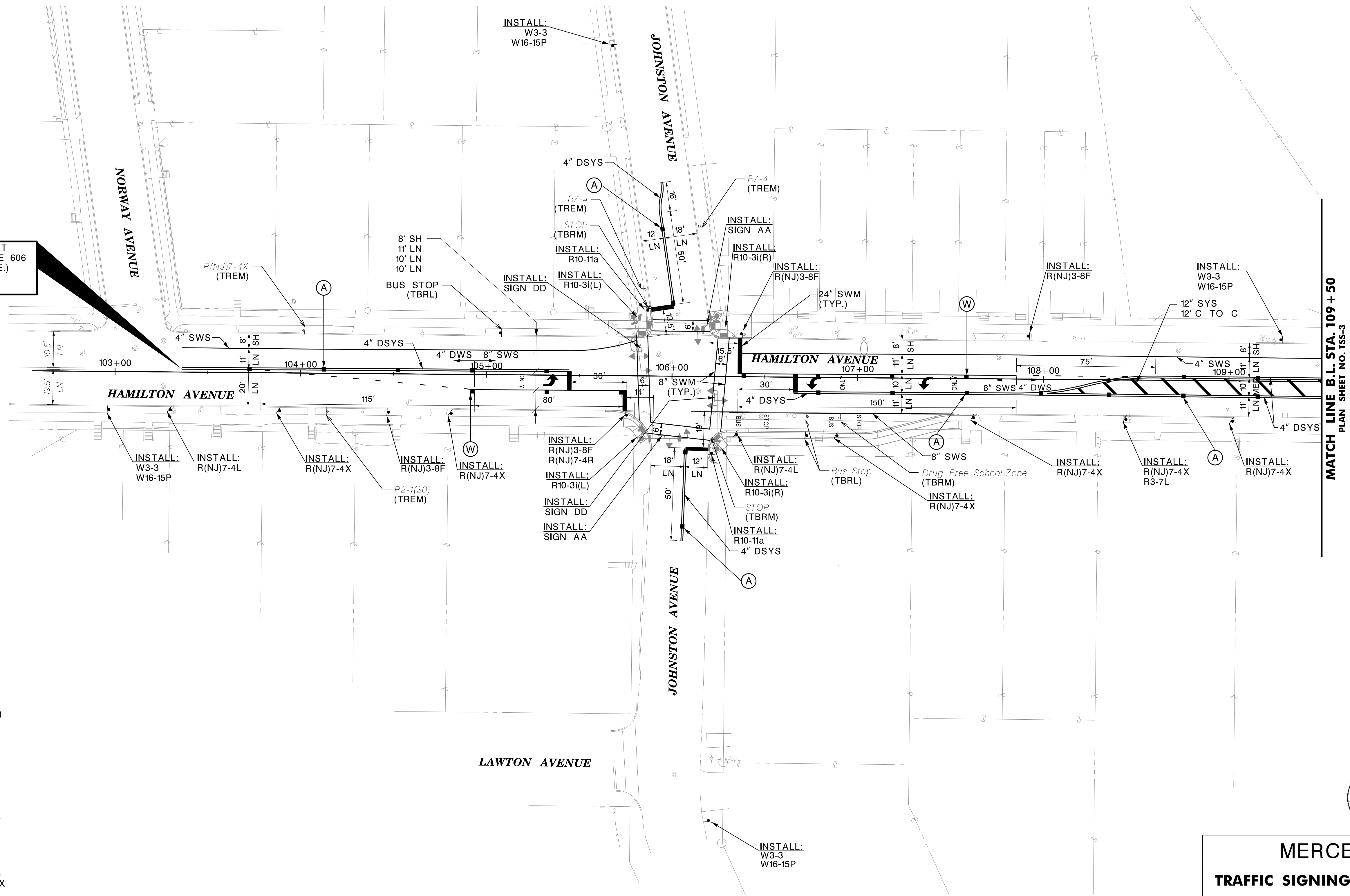

MATCH LINE B.L. STA. 109+50  
PLAN SHEET NO. TSS-3

**SIGNS ON THIS PLANSHEET**

- |           |                                 |
|-----------|---------------------------------|
| R2-1      | SPEED LIMIT 30                  |
| R3-7L     | LEFT LANE MUST TURN LEFT        |
| R(NJ)3-8F | TURN LANE                       |
| R(NJ)7-4L | NO STOPPING OR STANDING (LEFT)  |
| R(NJ)7-4R | NO STOPPING OR STANDING (RIGHT) |
| R(NJ)7-4X | NO STOPPING OR STANDING         |
| R10-11a   | NO TURN ON RED                  |
| W3-3      | SIGNAL AHEAD                    |
| W16-15P   | NEW (PLAQUE)                    |
| SIGN AA   | HAMILTON AVE                    |
| SIGN DD   | JOHNSTON AVE                    |

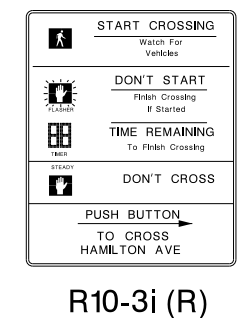
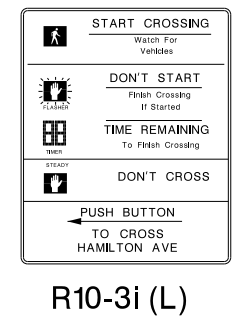
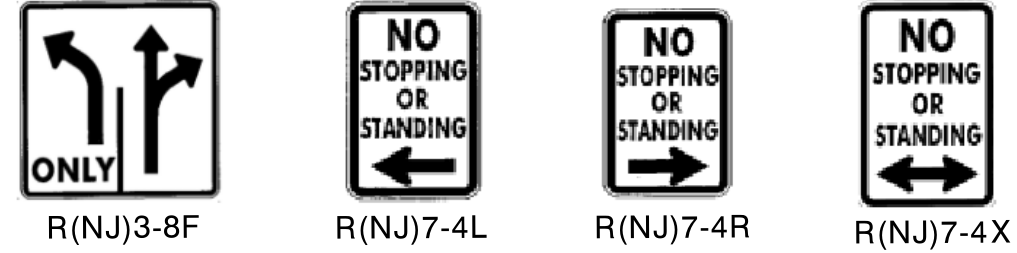

**LEGEND**

- (A) TWO-WAY PLOWABLE BI-DIRECTIONAL AMBER PAVEMENT REFLECTOR
- (W) TWO-WAY PLOWABLE MONO-DIRECTIONAL WHITE PAVEMENT REFLECTOR



DATE	AUTH.	BY	REVISIONS



**MERCER COUNTY**

**TRAFFIC SIGNING AND STRIPING PLANS**

IMPROVEMENTS ALONG HAMILTON AVE  
(CR 606) FROM JOHNSTON AVE  
TO KUSER RD (CR 619) / WARD AVE  
TOWNSHIP OF HAMILTON MERCER COUNTY NEW JERSEY

**GILBERTO R. BOSQUE**  
NEW JERSEY PROFESSIONAL ENGINEER LICENSE NO. 24GE0515200

*Gilberto Bosque* DATE: 9/11/20

**Michael Baker INTERNATIONAL** SCALE: 1" = 30' DATE: SEPTEMBER 2020  
DRAWN BY: MJA CHECK BY: SRH SHEET 44 OF 61

Baker PW Path Location: p:\proj\DCPWA\PP\Baker\miller\proj\hamilton\office\60216\_MCDOT-Traffic-Signing-Upgrade\CAD\DD\Plan\Striping\TSS-2.dgn

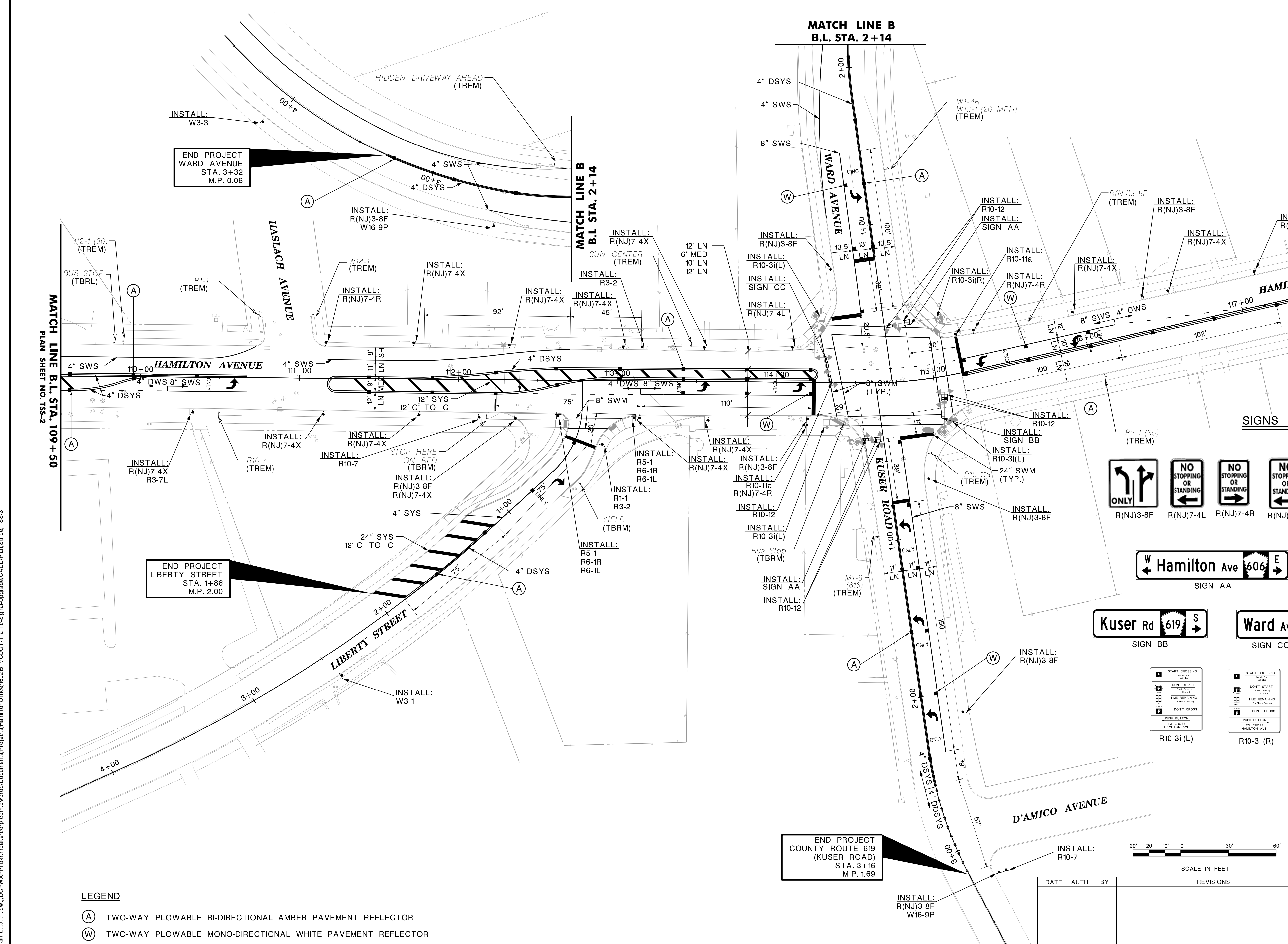
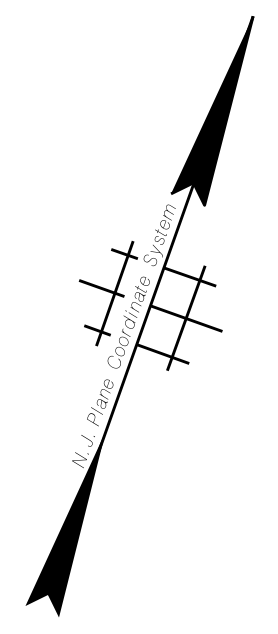

MATCH LINE B, STA. 109+50  
PLAN SHEET NO. TSS-2

MATCH LINE B  
B.L. STA. 2+14

END PROJECT  
WARD AVENUE  
STA. 3+32  
M.P. 0.06

END PROJECT  
COUNTY ROUTE 606  
(HAMILTON AVE.)  
STA. 117+83  
M.P. 2.24

END PROJECT  
LIBERTY STREET  
STA. 1+86  
M.P. 2.00

END PROJECT  
COUNTY ROUTE 619  
(KUSER ROAD)  
STA. 3+16  
M.P. 1.69

**SIGNS ON THIS PLANSHEET**

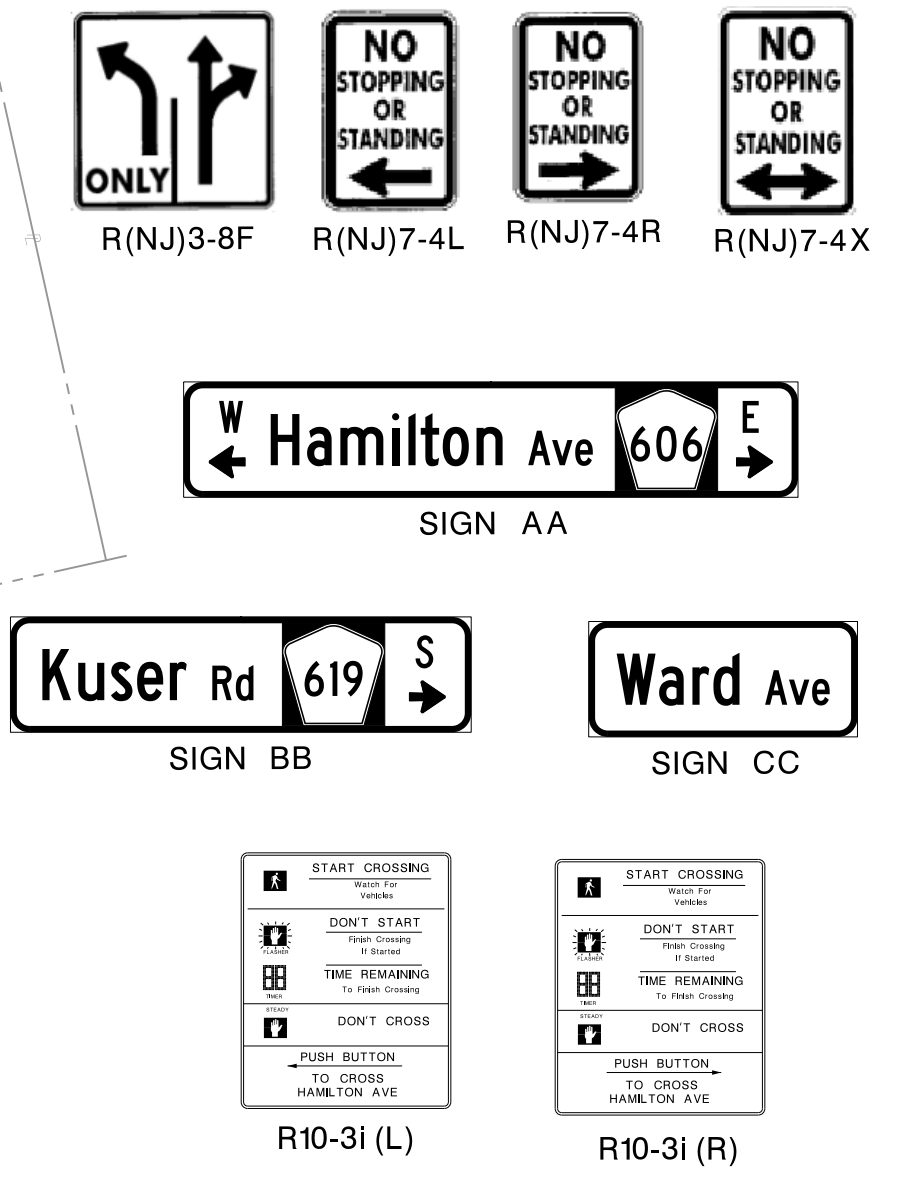

- R1-1 STOP
- R2-1 SPEED LIMIT XX
- R3-2 NO LEFT TURN
- R3-7L LEFT LANE MUST TURN LEFT
- R(NJ)3-8F TURN LANE
- R5-1 DO NOT ENTER
- R6-1R ONE WAY (RIGHT)
- R6-1L ONE WAY (LEFT)
- R(NJ)7-4L NO STOPPING OR STANDING (LEFT)
- R(NJ)7-4R NO STOPPING OR STANDING (RIGHT)
- R(NJ)7-4X NO STOPPING OR STANDING
- R10-7 DO NOT BLOCK INTERSECTION
- R10-11a NO TURN ON RED
- R10-12 LEFT TURN YIELD ON GREEN
- W1-4R REVERSE CURVE
- M1-6 COUNTY ROUTE 616
- W3-1 STOP AHEAD
- W3-3 SIGNAL AHEAD
- W13-1 ADVISORY SPEED XX MPH
- W14-1 NO OUTLET
- W16-9P AHEAD
- SIGN AA HAMILTON AVE
- SIGN BB KUSER RD
- SIGN CC WARD AVE

- LEGEND**
- (A) TWO-WAY PLOWABLE BI-DIRECTIONAL AMBER PAVEMENT REFLECTOR
  - (W) TWO-WAY PLOWABLE MONO-DIRECTIONAL WHITE PAVEMENT REFLECTOR



DATE	AUTH.	BY	REVISIONS



**MERCER COUNTY**

**TRAFFIC SIGNING AND STRIPING PLANS**

IMPROVEMENTS ALONG HAMILTON AVE  
(CR 606) FROM JOHNSTON AVE  
TO KUSER RD (CR 619) / WARD AVE

TOWNSHIP OF HAMILTON    MERCER COUNTY    NEW JERSEY

**GILBERTO R. BOSQUE**  
NEW JERSEY PROFESSIONAL ENGINEER LICENSE NO. 24GE0515200

*Gilberto Bosque*    DATE: 9/11/20

**Michael Baker INTERNATIONAL**    SCALE: 1" = 30'    DATE: SEPTEMBER 2020

DRAWN BY: MJA    CHECK BY: SRH    SHEET 45 OF 61

Baker PW Path Location: p:\w\DCP\WAPP\hcr.mbakercorp.com\p\proj\out\Documents\Project\Hamilton\Office\650216\_MCDOT-Traffic-Signing-Upgrade\CADD\Plan\Striping\TSS-3