

TYPICAL STRIPING DETAILS
NOT TO SCALE

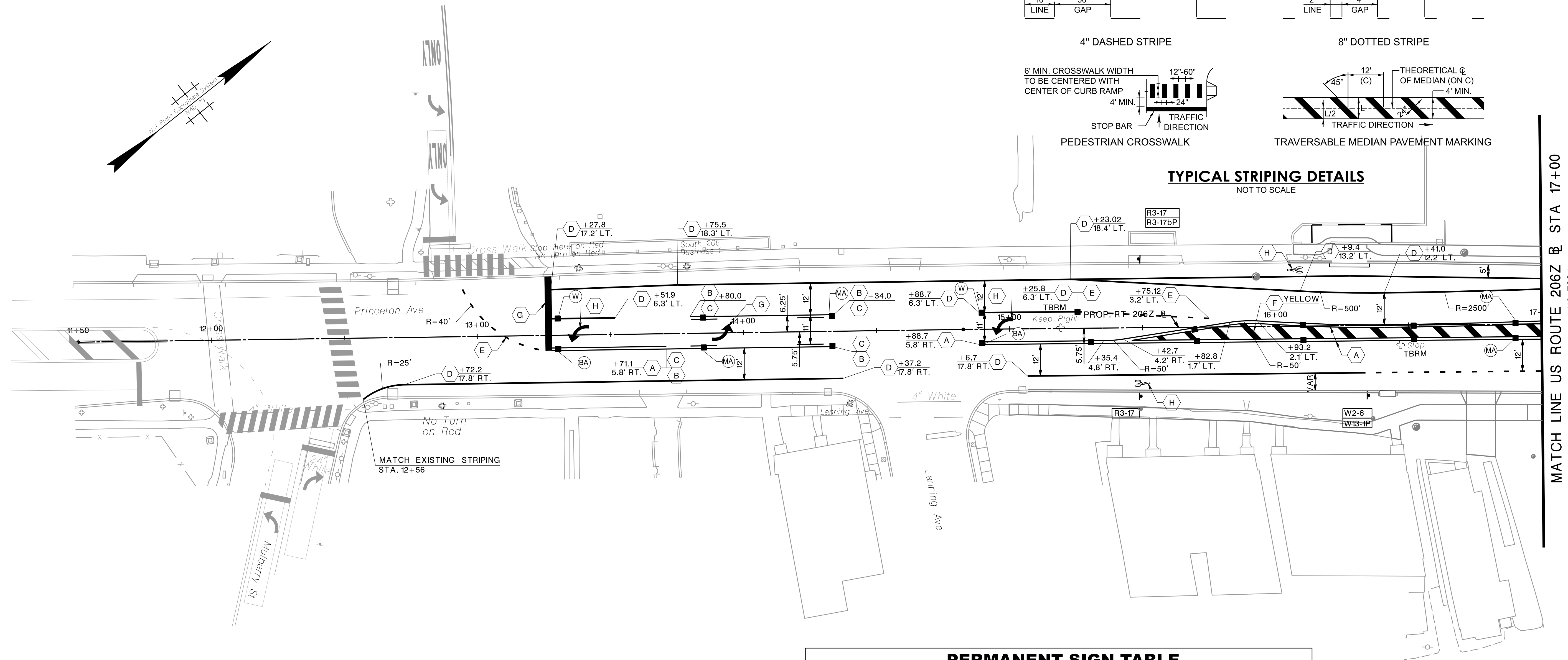

MATCH LINE US ROUTE 206Z @ STA 17+00
PLAN SHEET NO. TSS-2

GENERAL NOTES:

- FOR RPM LOCATIONS AND COLOR, REFER TO THE LATEST NJDOT "STANDARD CONSTRUCTION DETAILS, ROADWAY - TRAFFIC CONTROL - BRIDGE".
- ONLY SIGNS THAT ARE TO BE REMOVED, RELOCATED OR INSTALLED ARE SHOWN. EXISTING SIGNS TO REMAIN ARE NOT SHOWN. EXISTING SIGNS THAT ARE MOVED TO ACCOMMODATE CONSTRUCTION SHALL BE RESET AT THEIR CURRENT LOCATIONS.

SIGN PLACEMENT NOTES:

- WHERE A 2 FOOT OFFSET BETWEEN THE EDGE OF SIGN AND SHARED-USE PATH CANNOT BE ATTAINED, THE SIGN SHALL BE MOUNTED AT A VERTICAL HEIGHT OF NO LESS THAN 8 FEET. WHERE A 2 FOOT OFFSET BETWEEN THE EDGE OF SIGN AND SIDEWALK CANNOT BE ATTAINED, THE SIGN SHALL BE MOUNTED AT A VERTICAL HEIGHT OF NO LESS THAN 7 FEET.
- WHERE A 2 FOOT OFFSET IS PROVIDED BETWEEN THE EDGE OF THE SIGN AND THE SHARED-USE PATH OR SIDEWALK, THE SIGN SHALL BE MOUNTED AT A VERTICAL HEIGHT OF NO LESS THAN 4 FEET.
- WHERE A SIGN IS ADJACENT TO THE ROADWAY, IT SHALL BE PLACED AT A 2 FOOT MINIMUM OFFSET BETWEEN THE FACE OF CURB AND EDGE OF SIGN AND SHALL BE MOUNTED AT A VERTICAL HEIGHT OF NO LESS THAN 7 FEET.

LEGEND:

- | | |
|--|---|
| (A) 4" DOUBLE YELLOW STRIPE | (W) RPM, MONO-DIRECTIONAL, WHITE LENS |
| (B) 4" SOLID YELLOW STRIPE | (BA) RPM, BI-DIRECTIONAL, AMBER LENS |
| (C) 4" DASHED YELLOW STRIPE | (MA) RPM, MONO-DIRECTIONAL, AMBER LENS |
| (D) 6" SOLID WHITE STRIPE | (S) EXISTING SIGN |
| (E) 8" DOTTED WHITE STRIPE, 2' LINE W/ 4' GAP | (P) PROPOSED SIGN |
| (F) 24" TRAFFIC MARKING, LINE, 45°, 12" C. TO C. (WHITE OR YELLOW) | (+) EXISTING SIGN IN PROPOSED LOCATION |
| (G) 24" TRAFFIC MARKING, LINE (WHITE) | (TBRM) EXISTING SIGN TO BE REMOVED |
| (H) TRAFFIC MARKING, SYMBOL (WHITE) | (TBRL) EXISTING SIGN TO BE RELOCATED |

PERMANENT SIGN TABLE

SIGN DESIGNATION	MESSAGE	SIZE (IN x IN)	AREA (SF)	REQUIRED QUANTITY	TOTAL AREA (SF)
D1-1d (Mod 1)	PRINCETON AVE NORTH w/ DIAGONAL ARROW	78 x 24	13.0	1	13.0
D1-1d (Mod 2)	PRINCETON AVE SOUTH w/ DIAGONAL ARROW	78 x 24	13.0	1	13.0
M1-4	US 1	24 x 24	4.0	2	8.0
M4-3	BUSINESS	24 x 12	2.0	1	2.0
M4-5	TO	24 x 12	2.0	1	2.0
M6-2_R(21)	DIRECTIONAL ARROW (Right - Up 45)	21" x 15"	2.2	1	2.2
R1-2	YIELD	36" x 36" X 36"	4.5	6	27.0
R3-17	BIKE LANE (Symbol)	24" x 18"	3.0	7	21.0
R3-17bP	ENDS (plaque)	24" x 8"	1.3	3	4.0
R4-7	KEEP RIGHT (Symbol)	24" x 30"	5.0	3	15.0
R4-11	BICYCLES MAY USE FULL LANE	30" x 30"	6.3	2	12.5
R6-4	ROUNDABOUT DIRECTIONAL (2 chevrons)	30" x 24"	5.0	3	15.0
W11-2(36)	PEDESTRIAN (Symbol) - 36x36	36" x 36"	9.0	6	54.0
W13-1(15)	ADVISORY SPEED (15 MPH)	18" x 18"	2.3	3	6.8
W16-7P_L(24)	LEFT DOWNWARD DIAGONAL ARROW (plaque) - 24x12	24" x 12"	2.0	6	12.0
W2-6(30)	CIRCULAR INTERSECTION - 30x30	30" x 30"	6.3	3	18.8
SIGN TOTAL					227.0

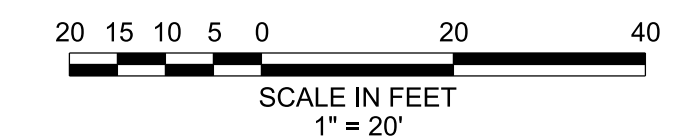

COUNTY OF MERCER

TRAFFIC SIGNING AND STRIPING PLANS

ROUNDABOUT - PRINCETON AVENUE (US 206Z) AND BRUNSWICK CIRCLE EXTENSION (CR 645)

URBAN ENGINEERS, INC.
 CERTIFICATE OF AUTHORIZATION NO. 24GA28033900
 DATE: 10/14/2022
 ADAM R. BROWN, P.E.
 NEW JERSEY PROFESSIONAL ENGINEER LICENSE NO. 24GE04781000

Urban Engineers, Inc., Cherry Hill, New Jersey

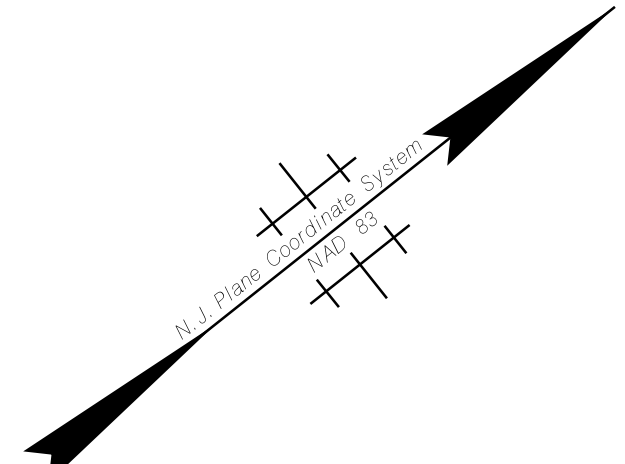

MATCH LINE US ROUTE 206Z @ STA 17+00
PLAN SHEET NO. TSS-1

MATCH LINE US ROUTE 206Z @ STA 33+00
PLAN SHEET NO. TSS-3

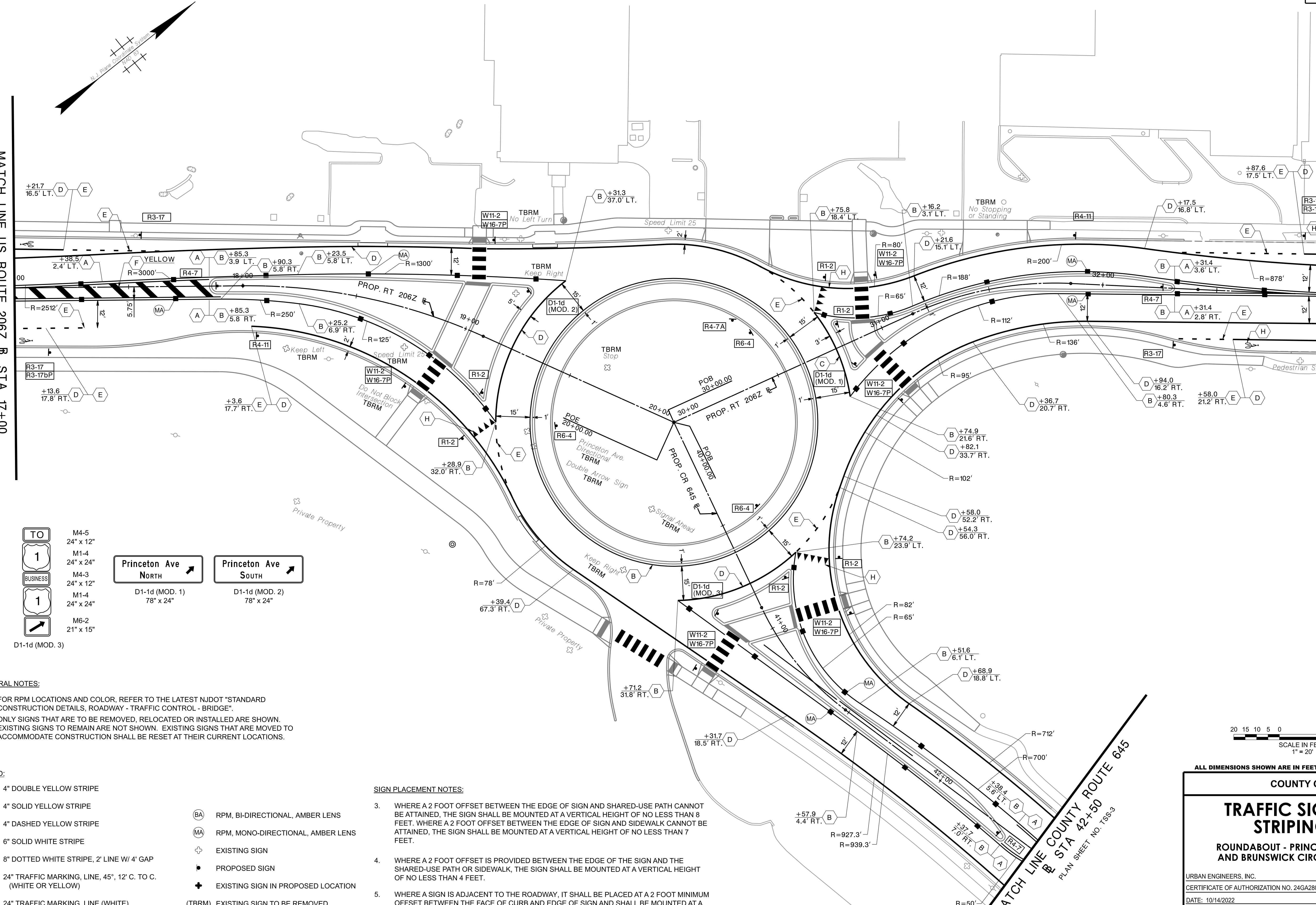

	M4-5 24" x 12"
	M1-4 24" x 24"
	M4-3 24" x 12"
	M1-4 24" x 24"
	M6-2 21" x 15"

D1-1d (MOD. 3)

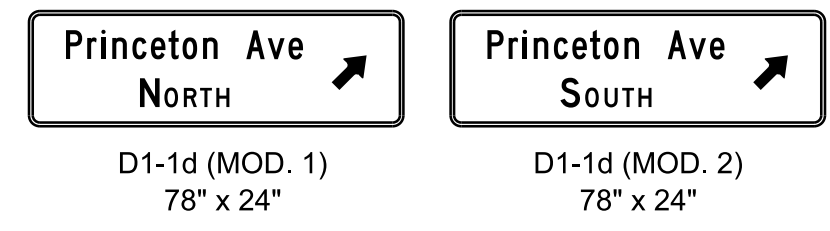

GENERAL NOTES:

- FOR RPM LOCATIONS AND COLOR, REFER TO THE LATEST NJDOT "STANDARD CONSTRUCTION DETAILS, ROADWAY - TRAFFIC CONTROL - BRIDGE".
- ONLY SIGNS THAT ARE TO BE REMOVED, RELOCATED OR INSTALLED ARE SHOWN. EXISTING SIGNS TO REMAIN ARE NOT SHOWN. EXISTING SIGNS THAT ARE MOVED TO ACCOMMODATE CONSTRUCTION SHALL BE RESET AT THEIR CURRENT LOCATIONS.

LEGEND:

	4" DOUBLE YELLOW STRIPE		RPM, BI-DIRECTIONAL, AMBER LENS
	4" SOLID YELLOW STRIPE		RPM, MONO-DIRECTIONAL, AMBER LENS
	4" DASHED YELLOW STRIPE		EXISTING SIGN
	6" SOLID WHITE STRIPE		PROPOSED SIGN
	8" DOTTED WHITE STRIPE, 2' LINE W/ 4' GAP		EXISTING SIGN IN PROPOSED LOCATION
	24" TRAFFIC MARKING, LINE, 45°, 12' C. TO C. (WHITE OR YELLOW)		EXISTING SIGN TO BE REMOVED
	24" TRAFFIC MARKING, LINE (WHITE)		EXISTING SIGN TO BE RELOCATED
	TRAFFIC MARKING, SYMBOL (WHITE)		

SIGN PLACEMENT NOTES:

- WHERE A 2 FOOT OFFSET BETWEEN THE EDGE OF SIGN AND SHARED-USE PATH CANNOT BE ATTAINED, THE SIGN SHALL BE MOUNTED AT A VERTICAL HEIGHT OF NO LESS THAN 8 FEET. WHERE A 2 FOOT OFFSET BETWEEN THE EDGE OF SIGN AND SIDEWALK CANNOT BE ATTAINED, THE SIGN SHALL BE MOUNTED AT A VERTICAL HEIGHT OF NO LESS THAN 7 FEET.
- WHERE A 2 FOOT OFFSET IS PROVIDED BETWEEN THE EDGE OF THE SIGN AND THE SHARED-USE PATH OR SIDEWALK, THE SIGN SHALL BE MOUNTED AT A VERTICAL HEIGHT OF NO LESS THAN 4 FEET.
- WHERE A SIGN IS ADJACENT TO THE ROADWAY, IT SHALL BE PLACED AT A 2 FOOT MINIMUM OFFSET BETWEEN THE FACE OF CURB AND EDGE OF SIGN AND SHALL BE MOUNTED AT A VERTICAL HEIGHT OF NO LESS THAN 7 FEET.

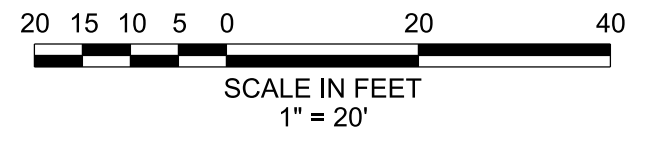

COUNTY OF MERCER

TRAFFIC SIGNING AND STRIPING PLANS

ROUNDBOUT - PRINCETON AVENUE (US 206Z) AND BRUNSWICK CIRCLE EXTENSION (CR 645)

URBAN ENGINEERS, INC.
 CERTIFICATE OF AUTHORIZATION NO. 24GA28033900
 DATE: 10/14/2022
 ADAM R. BROWN, P.E.
 NEW JERSEY PROFESSIONAL ENGINEER LICENSE NO. 24GE04781000

Urban Engineers, Inc., Cherry Hill, New Jersey

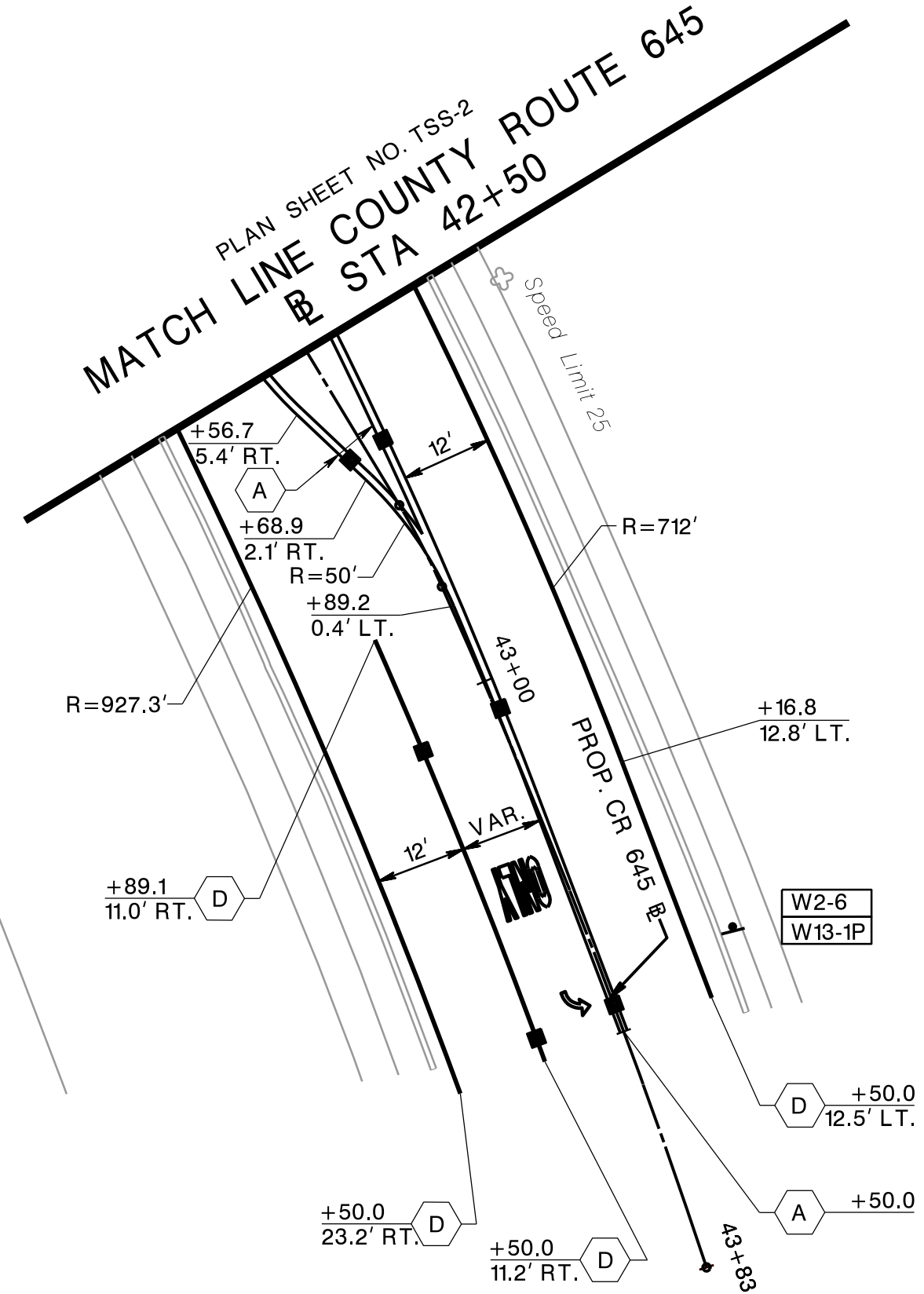
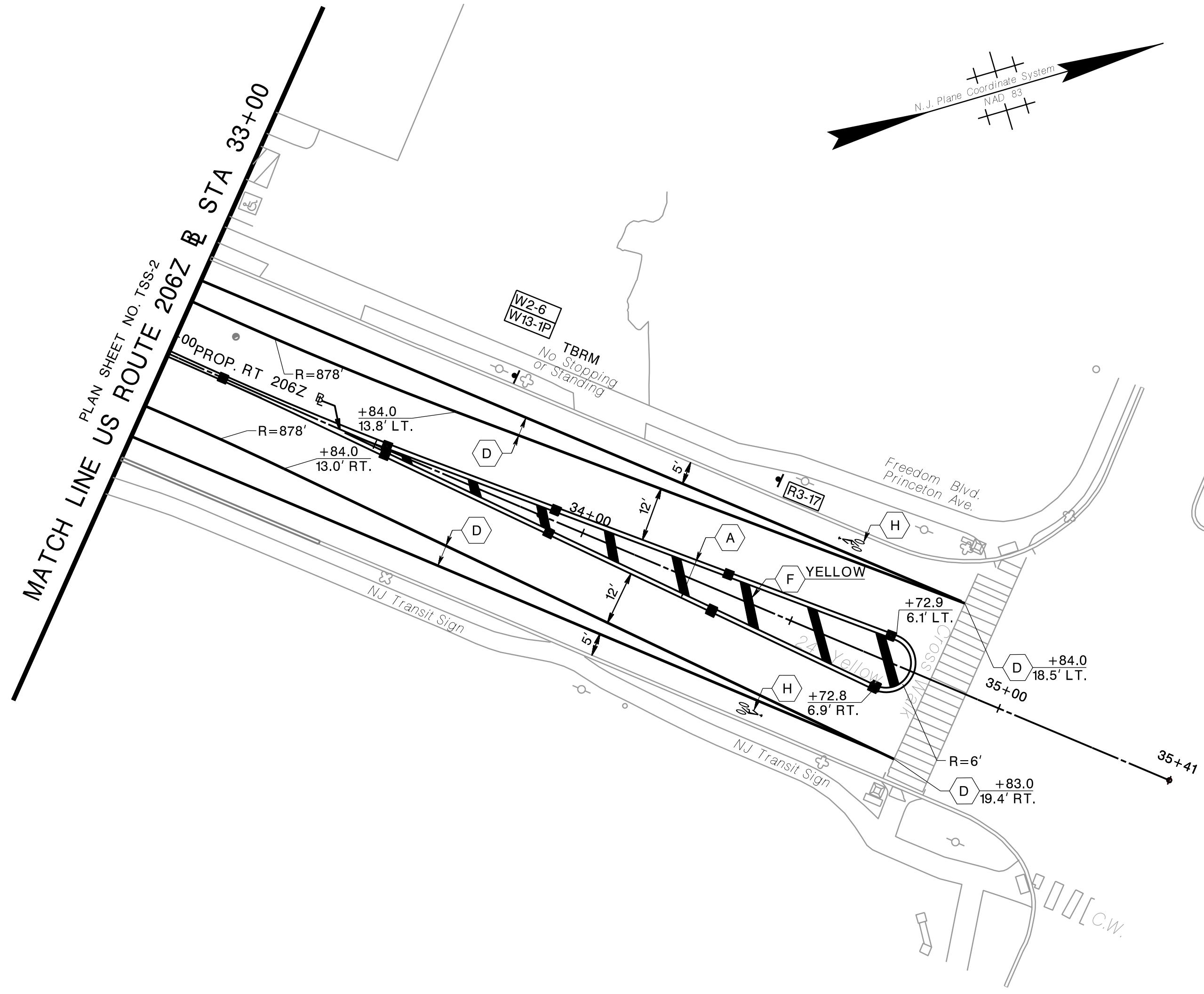

GENERAL NOTES:

- FOR RPM LOCATIONS AND COLOR, REFER TO THE LATEST NJDOT "STANDARD CONSTRUCTION DETAILS, ROADWAY - TRAFFIC CONTROL - BRIDGE".
- ONLY SIGNS THAT ARE TO BE REMOVED, RELOCATED OR INSTALLED ARE SHOWN. EXISTING SIGNS TO REMAIN ARE NOT SHOWN. EXISTING SIGNS THAT ARE MOVED TO ACCOMMODATE CONSTRUCTION SHALL BE RESET AT THEIR CURRENT LOCATIONS.
- WHERE A 2 FOOT OFFSET BETWEEN THE EDGE OF SIGN AND SHARED-USE PATH CANNOT BE ATTAINED, THE SIGN SHALL BE MOUNTED AT A VERTICAL HEIGHT OF NO LESS THAN 8 FEET. WHERE A 2 FOOT OFFSET BETWEEN THE EDGE OF SIGN AND SIDEWALK CANNOT BE ATTAINED, THE SIGN SHALL BE MOUNTED AT A VERTICAL HEIGHT OF NO LESS THAN 7 FEET.
- WHERE A 2 FOOT OFFSET IS PROVIDED BETWEEN THE EDGE OF THE SIGN AND THE SHARED-USE PATH OR SIDEWALK, THE SIGN SHALL BE MOUNTED AT A VERTICAL HEIGHT OF NO LESS THAN 4 FEET.
- WHERE A SIGN IS ADJACENT TO THE ROADWAY, IT SHALL BE PLACED AT A 2 FOOT MINIMUM OFFSET BETWEEN THE FACE OF CURB AND EDGE OF SIGN AND SHALL BE MOUNTED AT A VERTICAL HEIGHT OF NO LESS THAN 7 FEET.

SIGN PLACEMENT NOTES:

LEGEND:

- (A) 4" DOUBLE YELLOW STRIPE
- (B) 4" SOLID YELLOW STRIPE
- (C) 4" DASHED YELLOW STRIPE
- (D) 6" SOLID WHITE STRIPE
- (E) 8" DOTTED WHITE STRIPE, 2' LINE W/ 4' GAP
- (F) 24" TRAFFIC MARKING, LINE, 45°, 12' C. TO C. (WHITE OR YELLOW)
- (G) 24" TRAFFIC MARKING, LINE (WHITE)
- (H) TRAFFIC MARKING, SYMBOL (WHITE)

- (BA) RPM, BI-DIRECTIONAL, AMBER LENS
- (MA) RPM, MONO-DIRECTIONAL, AMBER LENS
- (+) EXISTING SIGN
- (+P) PROPOSED SIGN
- (+X) EXISTING SIGN IN PROPOSED LOCATION
- (TBRM) EXISTING SIGN TO BE REMOVED
- (TBRL) EXISTING SIGN TO BE RELOCATED

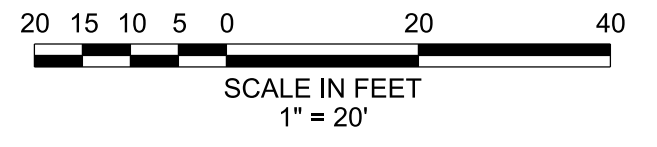

ALL DIMENSIONS SHOWN ARE IN FEET UNLESS OTHERWISE NOTED

COUNTY OF MERCER

TRAFFIC SIGNING AND STRIPING PLANS

ROUNDBOUT - PRINCETON AVENUE (US 206Z) AND BRUNSWICK CIRCLE EXTENSION (CR 645)

URBAN ENGINEERS, INC.
 CERTIFICATE OF AUTHORIZATION NO. 24GA28033900
 DATE: 10/14/2022
 ADAM R. BROWN, P.E.
 NEW JERSEY PROFESSIONAL ENGINEER LICENSE NO. 24GE04781000

Urban Engineers, Inc., Cherry Hill, New Jersey